

Tools Required for Installation:



tape measure



screw driver



drill

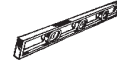

level



personal protective equipment

GRAB RAIL

1. Trim grab rail to desired length. Trim aluminum insert approximately 4" shorter than rail to allow space for end caps or rail connectors.
2. When using connectors between two sections of grab rail, lightly sand connector prior to applying PVC glue and inserting into rails.
3. To install grab rail brackets to post sleeves, drill 1/2" hole in desired location on sleeve and insert 1/2" bolt through bracket into sleeve. On the inside of the sleeve slide the 3" plate onto the bolt followed by a 1/2" lock washer and tighten with nut. Please check local building codes for correct grab rail height. When the bracket is secured, the cap can be installed on the sleeve using PVC glue.
4. The grab rail will be attached to brackets by pre-drilling 1/8" holes into rail where screw holes are located on bracket and inserting 1" screws through bracket into the rail.
5. End caps for the grab rail should be secured with PVC glue. After inserting the cap it may be necessary to temporarily tape the cap to the rail until PVC glue has cured.

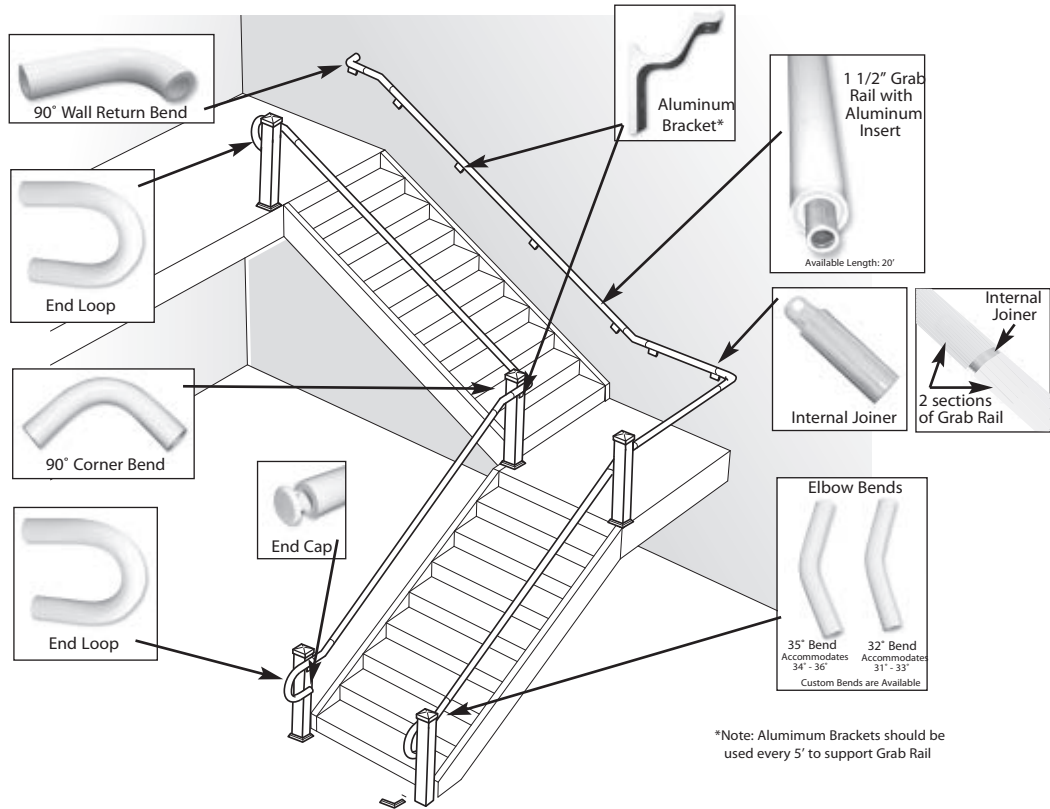

*Note: Aluminum Brackets should be used every 5' to support Grab Rail