

12" Balustrade System
Baluster - Rosedale(RL) (continued)

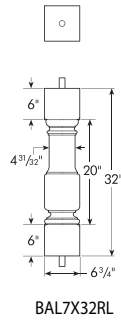

NEW BAL7X32RL

8 7/8"

12" Balustrade System
Baluster - Claremont(CL)

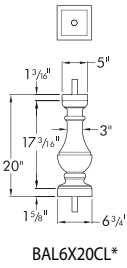

BAL6X20CL*

7"

*Cannot be used for stair applications.

12" Balustrade System
Baluster - Jillian (JI)

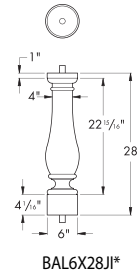

NEW BAL6X28JI*

7 15/16"

*Cannot be used for stair applications.

12" Balustrade System
Baluster - Trinity(TY)

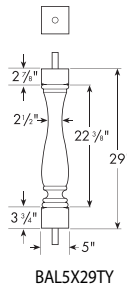

BAL5X29TY

6 7/16"

Maximum Center-to-Center Distance To Meet 4" Rule.
(See Page 2 BL For Details)

Part Number

12" Balustrade System
Baluster - Square(SQ)

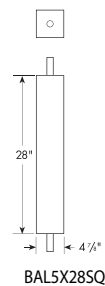

NEW BAL5X28SQ

8 13/16"