

7" Balustrade System  
Baluster - Trinity(TY)

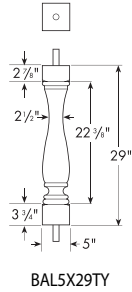

BAL5X29TY

Part Number

Maximum Center-to-Center Distance To Meet 4" Rule.  
(See Page 2 BL For Details)

BAL5X29TY

6 7/16"

7" Balustrade System  
Baluster - Woodruff(WF)

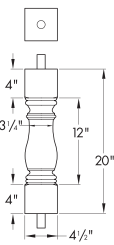

BAL5X20WF

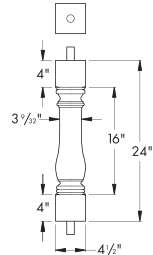

BAL5X24WF

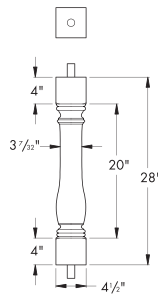

BAL5X28WF

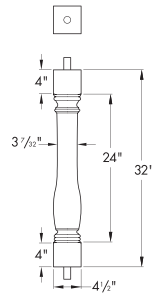

BAL5X32WF

**NEW** BAL5X20WF

7 3/16"

**NEW**

**NEW** BAL5X28WF

7 3/16"

**NEW**